

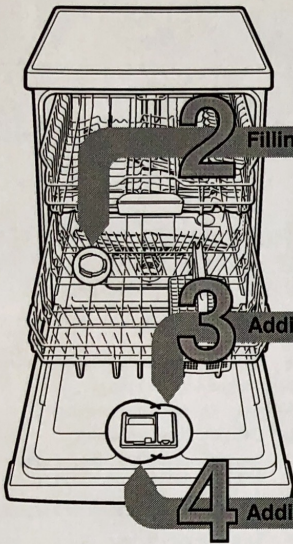

Brief and handy:
everything your dishwasher
needs ...

Before using for the first time,
read the Installation Instructions
and Operating Instructions!



1

Adjusting the water softening system *

Ask your water supply
company what the water
hardness is and enter ...

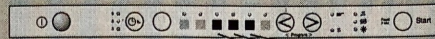

*Clarke	Hardness range	mmol/l	Setting	A	B	C
0-8	soft	0-1,1	0	○	○	○
9-20	medium	1,2-2,9	1	●	○	○
21-26	hard	3,0-3,7	2	●	●	○
27-44	hard	3,8-6,2	3	●	●	●

* only before the first wash
or if the water hardness
has been changed

Quickly sorted ...

How to adjust

- Switch on ON/OFF switch.
 - Hold down button > and press START button until and flash.
 - Release the buttons.
 - The Salt refill indicator Dry indicator flash.
 - The A indicator lights up (= level 1).
- Change the setting as follows:
- Press the < button until the required setting has been selected.
 - Press START button.
 - The and displays go out. The selected setting is saved.
 - Close the door.

2 Filling the salt dispenser

Dissolves limescale (not necessary when set to 0!) ...

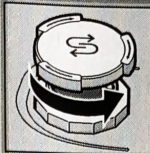

Open
the lid.

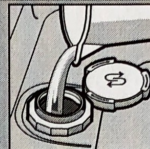

Only fill the salt
dispenser with
water before
the first wash.

For optimal washing results



Add
special salt
(never use
detergent!).

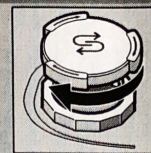

Close the lid.
Rinse immediately.

3

3 Adding rinse aid

Gets it sparkling clean ...

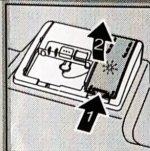

Press marking 1,
lift lid 2.



For optimum drying results

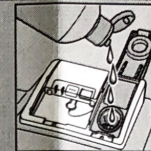

Add
rinse aid.

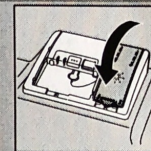

Close lid.
CLICK!

4

4 Adding detergent

A lot of dirt, a lot of detergent ...

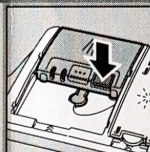

If required,
open the cover
(press button).

Attention:
Combination
products
are not suitable
for all programmes,
follow
manufacturer's
instructions.

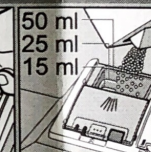

Pour detergent
into the dry
detergent
dispenser only.

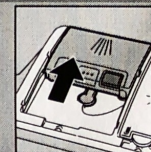

Slide cover
shut, press.
PLOP!

5

5 Switching on the appliance

6

6 Select programme

Quick, economical or intensive ...

Overview of programmes

The max. possible number of programmes
is illustrated in this overview.
The corresponding programmes for your appliance
can be found on the fascia.

The programme data has been measured in the
laboratory according to European standard EN 60436.
Deviations are possible in practice.
* half normal load

The programme duration will be different if the machine is short of rinse additive or the function is turned off.

Intensive 70°	Mix 65°	Eco 50°	Gentle 40°	Quick 45°	Prerinse

Duration: hs : min	← 3:30 - 1:05 →	← 0:29* →	← 0:15 →
Energy consumption in kWh	← 1,500 - 0,750 →	← 0,800 →	← 0,050 →
Water consumption in litres	← 15 - 9 →	← 10 →	← 4 →

9

9 Switch off the appliance

Everything o.k. ...



**Express Wash/
Speed Perfect
(VarioSpeed)**
... is obtained by increased
energy consumption at a
constant cleaning
performance.



Half load
... for a few items,
saves water, energy
and time.



Intensive zone
... perfect for
a mixed load.
Washing pressure
and washing temperature
are increased slightly.



Hygiene
... the temperature
is increased during
the final rinse process.
This increases
the hygiene status.



Extra drying
... improves the drying
result by increased
temperature
in the final rinse.
(Please take care
with delicate dishes.)

Additional options **

Flexibility ...

** depending on model

Maintenance and care

Filters
... check,
if required,
clean.

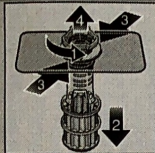

Rotate
filter cylinder,
remove filter
system ...



rinse
under
running
water ...

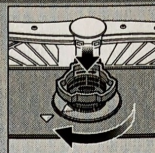

insert ...

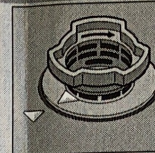

Screw on
filter system
**NOTE
MARK!**

Cleaning waste water pump

- Pull out the mains plug.
- Remove filters and scoop out water.
- Lever off cover (A).
- Check area around the fan impeller for foreign objects.
- Click cover shut (B).
- Insert filters.

Spray arms
... Remove
blockages/
deposits.

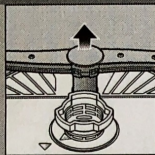

pull lower arm
upwards ...

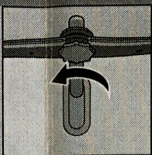

unscrew
upper arm ...

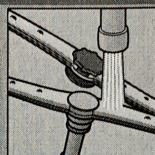

clean spray nozzles
under running water
(if required
use toothpicks) ...

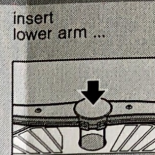

insert
lower arm ...

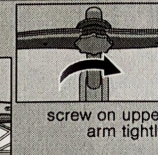

screw on upper
arm tightly

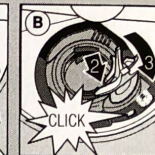
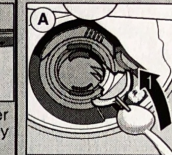

Rectifying minor faults yourself ...

... as it is worth doing it yourself!

More information can be found in the operating instructions

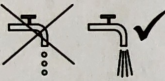
Fault	Possible causes	Remedial action
Display "A" is lit	Supply fitting jammed or calcified  Waste water hose is blocked or kinked Cover not attached to waste water pump Waste water pump blocked	<ul style="list-style-type: none"> ▶ Open supply fitting. ▶ 1. Unscrew water connection. ▶ 2. Clean filter in the water connection. ▶ 3. Flow rate must be min. 10 l/min., when water supply is open. ▶ If the flow rate is less, replace the supply fitting. ▶ Install supply hose without kinks. ▶ Install waste water hose without kinks. ▶ Attach cover (see above). ▶ Clean waste-water pump (see above).
Display "B" flashes	Appliance has technical defect	<ul style="list-style-type: none"> ▶ Call factory customer service (state fault display). ▶ Unplug appliance.
Residual water in the appliance	The programme has not yet ended	<ul style="list-style-type: none"> ▶ Switch on and close the appliance or terminate the programme (see Terminating the programme).
Rust on the cutlery	Cutlery not rust-resistant Hard knife blades are more susceptible Extraneous rust	<ul style="list-style-type: none"> ▶ Use dishwasher-proof cutlery. ▶ Never wash rusting parts in the appliance.

Fault	Possible causes	Remedial action
Utensils are not clean Sand or gritty residue on the utensils 	<ul style="list-style-type: none"> ▶ Utensils are situated close together or one above the other ▶ Too little detergent ▶ Unsuitable programme selected ▶ Spray arm nozzles blocked ▶ Filters dirty, not seated firmly ▶ Spray arms blocked 	<ul style="list-style-type: none"> ▶ Separate the utensils, prevent contact points. ▶ Follow manufacturer's instructions (detergent). ▶ Select a more intensive programme. ▶ Clean the spray arms (see above). ▶ Clean the filters (see above). ▶ Arrange the utensils so that the spray arms can rotate freely.
Stains and streaks	Rinse aid dosage too high/too low	<ul style="list-style-type: none"> ▶ Streaks: reduce dosage. ▶ Water or limescale stains: increase dosage.
Utensils not dry	Rinse aid The combined detergent used has a poor drying performance Appliance setting	<ul style="list-style-type: none"> ▶ Increase dosage. ▶ Change the product. ▶ Use rinse aid. ▶ Activate intensive drying (depending on model).
Milky deposits on the utensils (can be removed)	Water softening system incorrectly set No salt	<ul style="list-style-type: none"> ▶ Correctly set water softening system. ▶ Refill with special salt.
Milky deposits, glasses cloudy/tarnished (cannot be removed)	Glasses not dishwasher-proof	<ul style="list-style-type: none"> ▶ Use dishwasher-proof glasses. ▶ Use a detergent suitable for glasses.
Plastic/utensils discoloured	Too little detergent Discoloration caused by food colourings (tomato sauce)	<ul style="list-style-type: none"> ▶ Follow manufacturer's instructions (detergent). ▶ Discoloration is harmless; subsequent rinse cycles will cause it to fade.

Terminating the programme ...

While the programme is running, press the START button for approx. 3 sec. (Reset) until all displays go out.



The remaining programme sequence for draining the residual water takes approx. 1 minute.

Loading the dishwasher correctly ...

Dishwasher-proof utensils not soiled with ash, wax, lubricating grease, ink or adhesive labels; remove large remnants of jam, milk products and food according to the operating instructions and check that the spray arms can rotate freely.